

2x ϕ 3.05±0.2 [.120±.008] thru
 \square ϕ 5.99±0.25 [.236±.010]
 contact O.D.

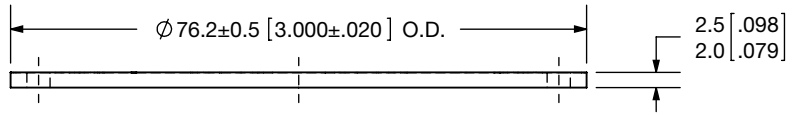

Typical	
Resistance*	15 - 25 Ω
Voltage	170 volts
Current	20 amps
Power	3000 watts
*Resistance Room Temp: R@800°C ~ 1/2R Room Temp	

THE INFORMATION CONTAINED IN THIS DRAWING IS THE SOLE PROPERTY OF MOMENTIVE PERFORMANCE MATERIALS. ANY REPRODUCTION IN PART OR AS A WHOLE WITHOUT THE WRITTEN PERMISSION OF MOMENTIVE PERFORMANCE MATERIALS IS PROHIBITED.
 Momentive and the Momentive logo are trademarks of Momentive Performance Materials Inc.

DIMENSIONS ARE IN: INCHES
 TOLERANCES: UNLESS OTHERWISE SPECIFIED
 ANGULAR: MACH \pm 5°
 TWO PLACE DECIMAL: \pm 0.01
 THREE PLACE DECIMAL: \pm 0.005

	NAME	DATE
DRAWN BY:	JMM	4/8/08
ENGINEER:	TJH	
APPROVED BY:	TJH	4/16/08
CNC:		
ITEM #:	HTR0063	
CMM#		
WORK ORDER:		
SALES ORDER:		



TITLE:
HT-63 Standard Heater Final
****External Details****

EXPORT CONTROL STATUS:
IS THIS DOCUMENT EXPORT CONTROLLED? **No**

TITLEBLOCK VERSION:
 MOMENTIVE TITLEBLOCK A INCH V1.0 4/07

MATERIAL:
 PBN/PG
 TREATMENT:

FORMER UCAR/ACC #:
 HTRSK32, HTR\0638A

CUST DWG #:

RFQ #:

DRAWING NUMBER:
080404

SCALE: 1:1

REV
 -

SHEET 1 OF 1