

61.47±0.2 [2.420±.008] \varnothing to \varnothing

2x $\varnothing 4.22 \pm 0.2$ [.166±.008] thru
 $\square \varnothing 9.53 \pm 0.25$ [.375±.010]
 contact O.D.

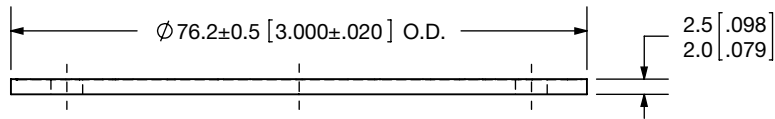
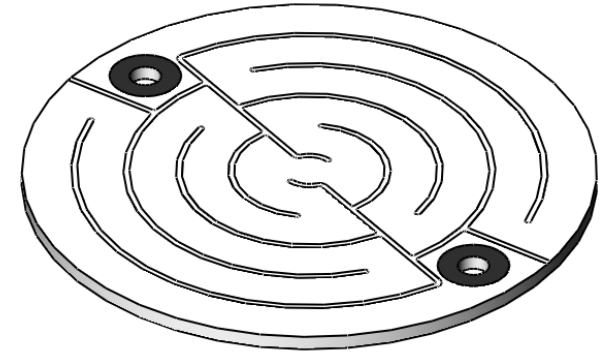

$\varnothing 76.2 \pm 0.5$ [3.000±.020] O.D.

2.5 [.098]
 2.0 [.079]

Typical	
Resistance*	22 - 35 Ω
Voltage	208 volts
Current	20 amps
Power	3000 watts
*Resistance Room Temp: R@800°C ~ 1/2R Room Temp	

THE INFORMATION CONTAINED IN THIS DRAWING IS THE SOLE PROPERTY OF MOMENTIVE PERFORMANCE MATERIALS. ANY REPRODUCTION IN PART OR AS A WHOLE WITHOUT THE WRITTEN PERMISSION OF MOMENTIVE PERFORMANCE MATERIALS IS PROHIBITED.

Momentive and the Momentive logo are trademarks of Momentive Performance Materials Inc.

DIMENSIONS ARE IN: mm [in]

TOLERANCES: UNLESS OTHERWISE SPECIFIED

ANGULAR: MACH $\pm .5^\circ$
 TWO PLACE DECIMAL: $\pm .3$ [0.01]
 THREE PLACE DECIMAL: $\pm .13$ [0.005]

NAME

DATE

DRAWN BY: JMM 4/8/08
 ENGINEER: TJH
 APPROVED BY: TJH 4/16/08
 CNC:



TITLE:
HT-45 Standard Heater Final
****External Details****

EXPORT CONTROL STATUS:

IS THIS DOCUMENT EXPORT CONTROLLED? **No**

MATERIAL:
 PBN/PG
 TREATMENT:

FORMER UCAR/ACC #:
 HTRSK9, HTR\0685

CUST DWG #:

ITEM #:
 HTR0045
 CMM#

DRAWING NUMBER:
080398

REV
 -

TITLEBLOCK VERSION:

MOMENTIVE TITLEBLOCK A INCH V1.0 4/07

RFQ #:

WORK ORDER: SALES ORDER:

SCALE: 1:1

SHEET 1 OF 1