

2x  $\varnothing 4.22 \pm 0.2$  [.166±.008] thru  
 $\square \varnothing 9.53 \pm 0.25$  [.375±.010]  
 contact O.D.

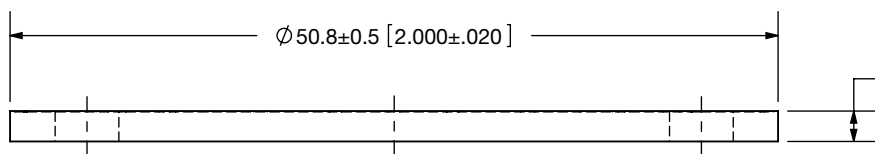

| Typical   |                  |
|---|------------------|
| Resistance*   | 15 - 25 $\Omega$ |
| Voltage   | 110 volts        |
| Current   | 15 amps          |
| Power   | 1300 watts       |
| *Resistance Room Temp:<br>$R@800^{\circ}\text{C} \sim 1/2R$ Room Temp |                  |

THE INFORMATION CONTAINED IN THIS DRAWING IS THE SOLE PROPERTY OF MOMENTIVE PERFORMANCE MATERIALS. ANY REPRODUCTION IN PART OR AS A WHOLE WITHOUT THE WRITTEN PERMISSION OF MOMENTIVE PERFORMANCE MATERIALS IS PROHIBITED.

Momentive and the Momentive logo are trademarks of Momentive Performance Materials Inc.

**DIMENSIONS ARE IN: mm [in]**  
 TOLERANCES: UNLESS OTHERWISE SPECIFIED  
 ANGULAR: MACH  $\pm .5^{\circ}$   
 TWO PLACE DECIMAL:  $\pm .3$  [0.01]  
 THREE PLACE DECIMAL:  $\pm .13$  [0.005]

|              | NAME | DATE    |
|--------------|------|---------|
| DRAWN BY:    | JMM  | 4/8/08  |
| ENGINEER:    | TJH  |         |
| APPROVED BY: | TJH  | 4/16/08 |
| CNC:         |      |         |

|              |         |
|--------------|---------|
| ITEM #:      | HTR0043 |
| CMM#         |         |
| WORK ORDER:  |         |
| SALES ORDER: |         |

**MOMENTIVE™**

TITLE:  
**HT-43 Standard Heater Final**  
**\*\*External Details\*\***

|                                  |          |
|----------------------------------|----------|
| DRAWING NUMBER:<br><b>080391</b> | REV<br>- |
|----------------------------------|----------|

SCALE: 2:1 SHEET 1 OF 1

EXPORT CONTROL STATUS:

**IS THIS DOCUMENT EXPORT CONTROLLED?** **No**

MATERIAL:  
 PBN/PG  
 TREATMENT:  
 FORMER UCAR/ACC #:  
 HTRST16, HTR\0686  
 CUST DWG #:

RFQ #:

TITLEBLOCK VERSION:

MOMENTIVE TITLEBLOCK A INCH V1.0 4/07